

# Step 1: Measure your Truck Bed Footprint

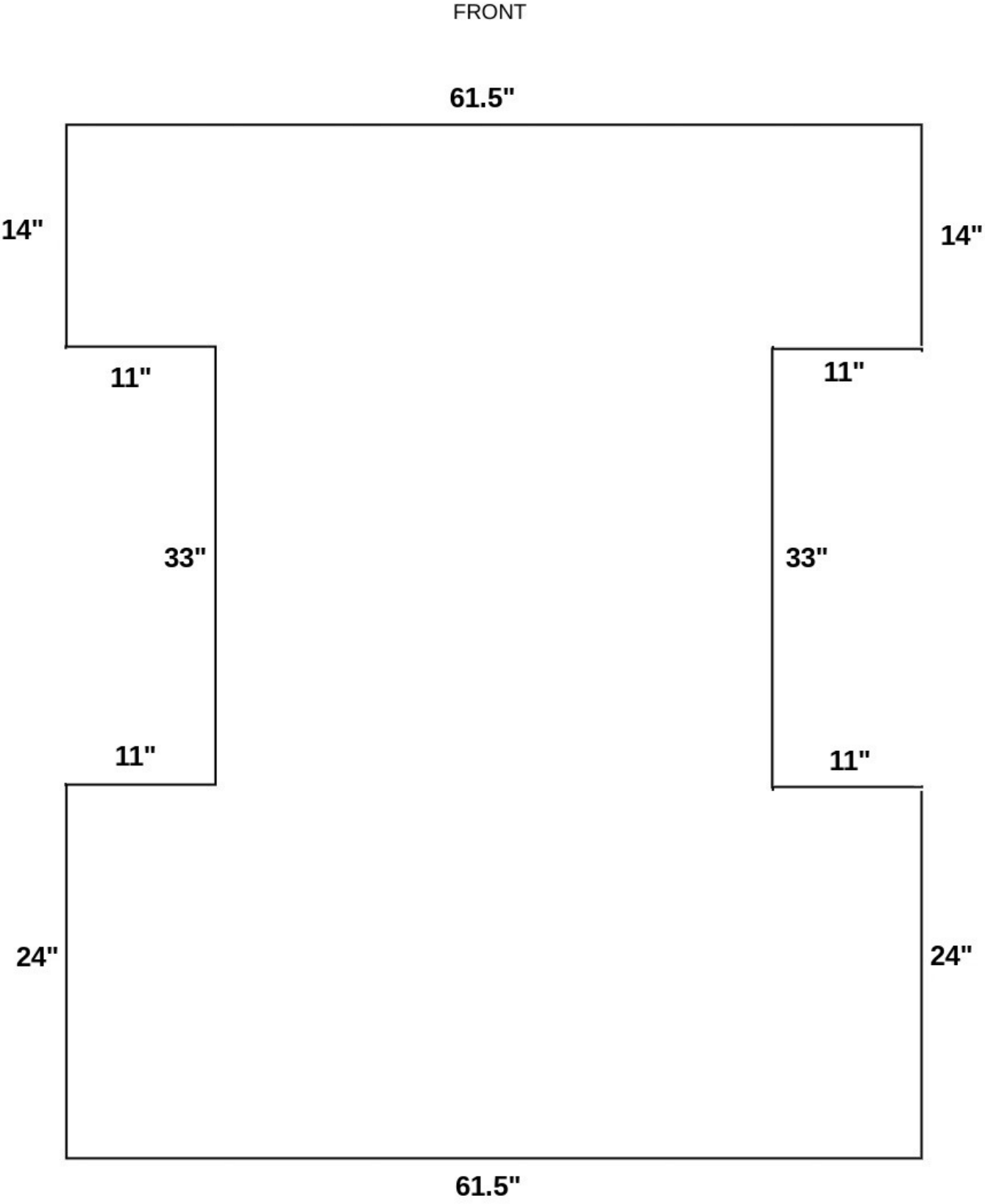

# STEP 2: Make the DIY Truck Camper Sleeping Platform Base

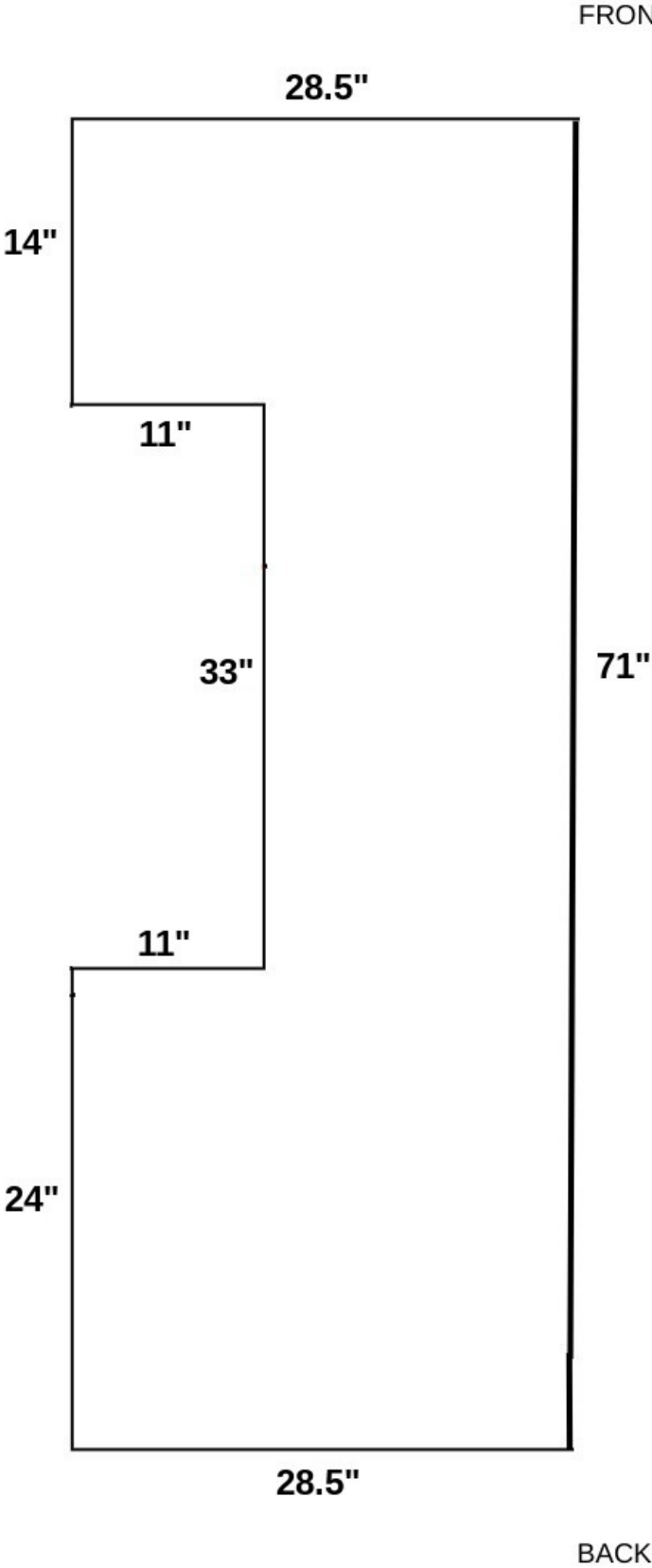

**GUIDE**

- = Kreg Jig Joint
- = 3/4" Plywood Supports (Cut 7" Tall)



# STEP 3: Build the DIY Truck Camper Sleeping Platform Supports

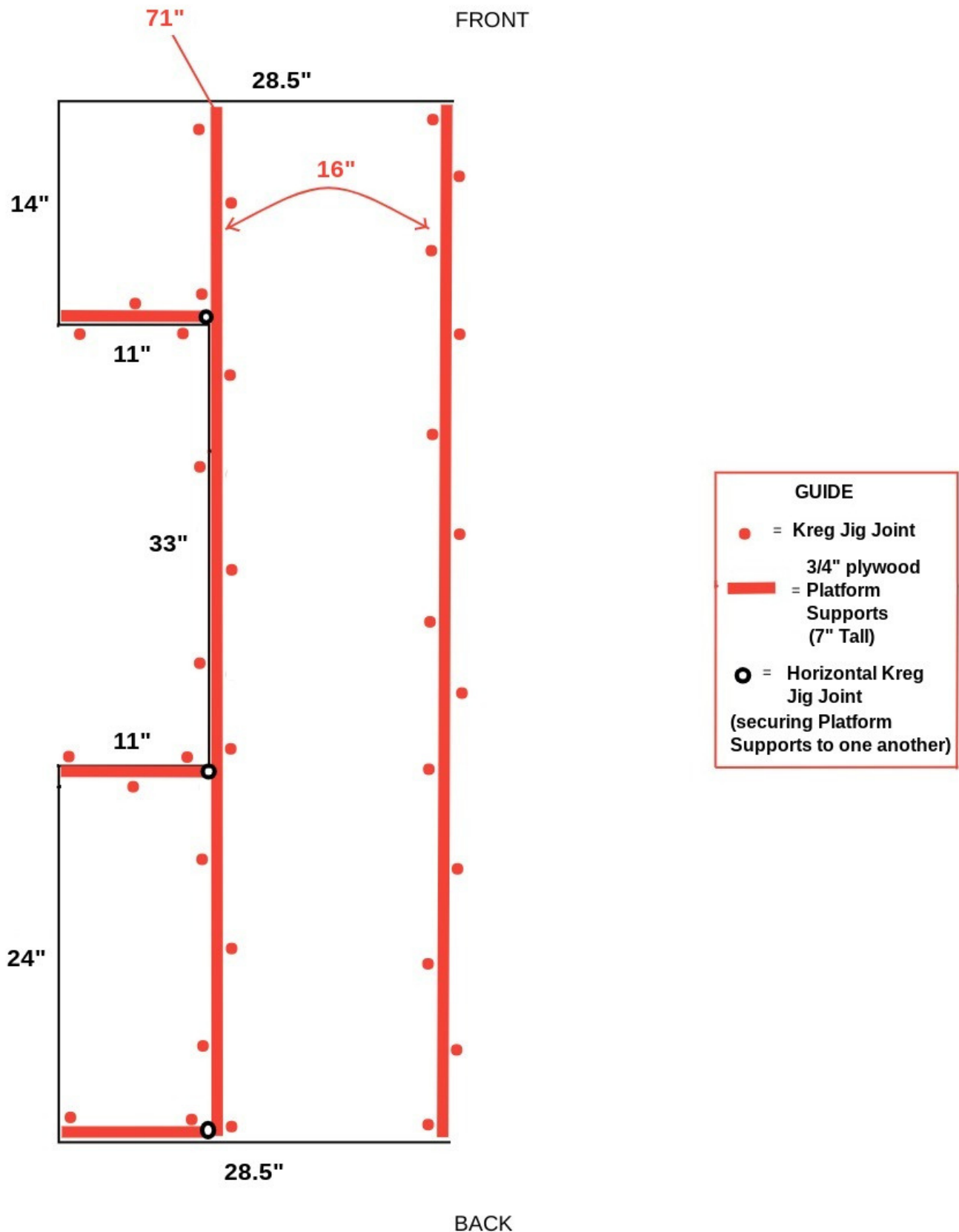

# STEP 4: Build the DIY Truck Camper Sleeping Platform Drawer

FRONT

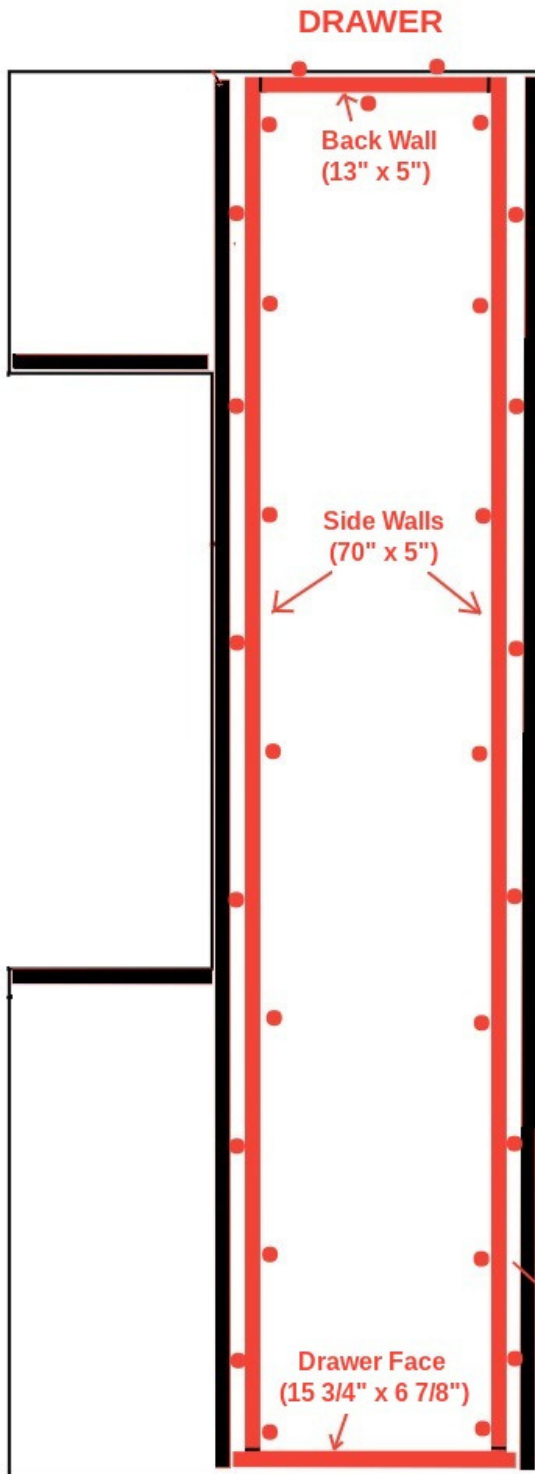

## GUIDE

● = Vertical Kreg  
Jig Joint

— = 3/4" Plywood

\* Drawer Base Dimensions = 70" x 14 1/2"

\* Drawer Walls are mounted on top of the Drawer Base and  
adjoined to one another with Horizontal Kreg Jig Joints

\* Drawer Face is mounted to the end of the Drawer Base  
AND Drawer Walls with Horizontal Kreg Jig Joints

BACK



TAKETHETRUCK.COM

# STEP 5: Add Platform Support Width Addition for the DIY Truck Camper Sleeping Platform Cover

FRONT

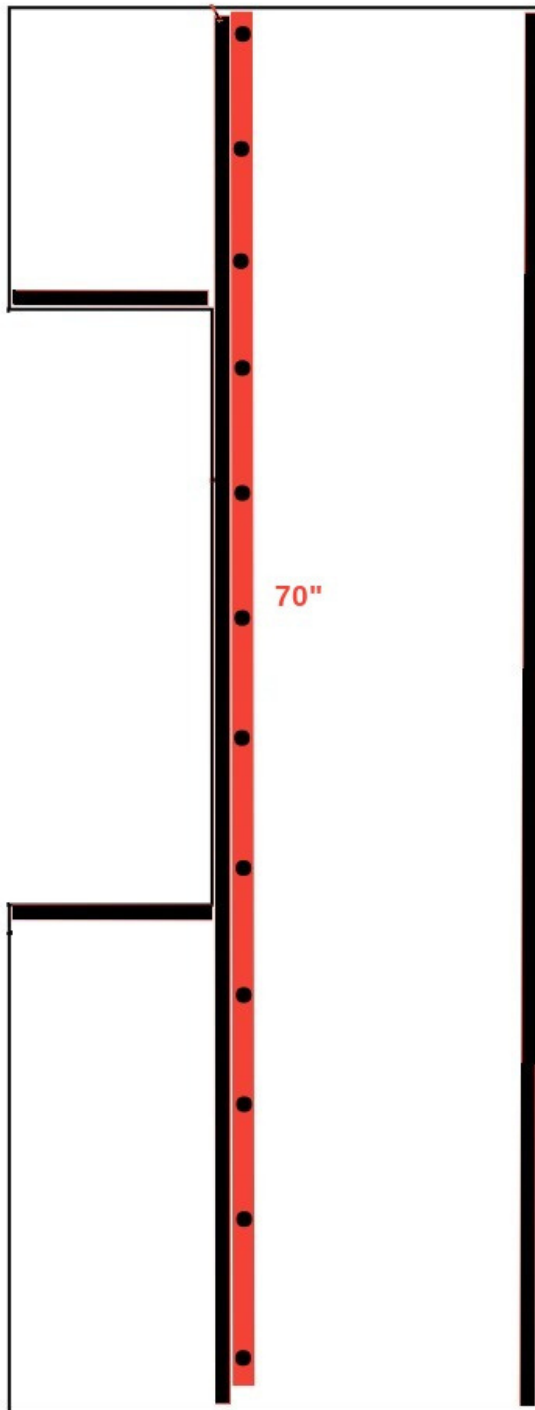

## GUIDE

- = Horizontal Kreg Jig Joint
- = 2x1" oak board (attached flush to the top of the Vertical Platform Support using horizontal kreg jig joints)

BACK



TAKETHETRUCK.COM

# STEP 6: Make The DIY Truck Camper Sleeping Platform Cover

FRONT

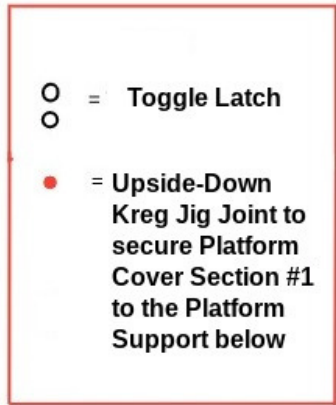
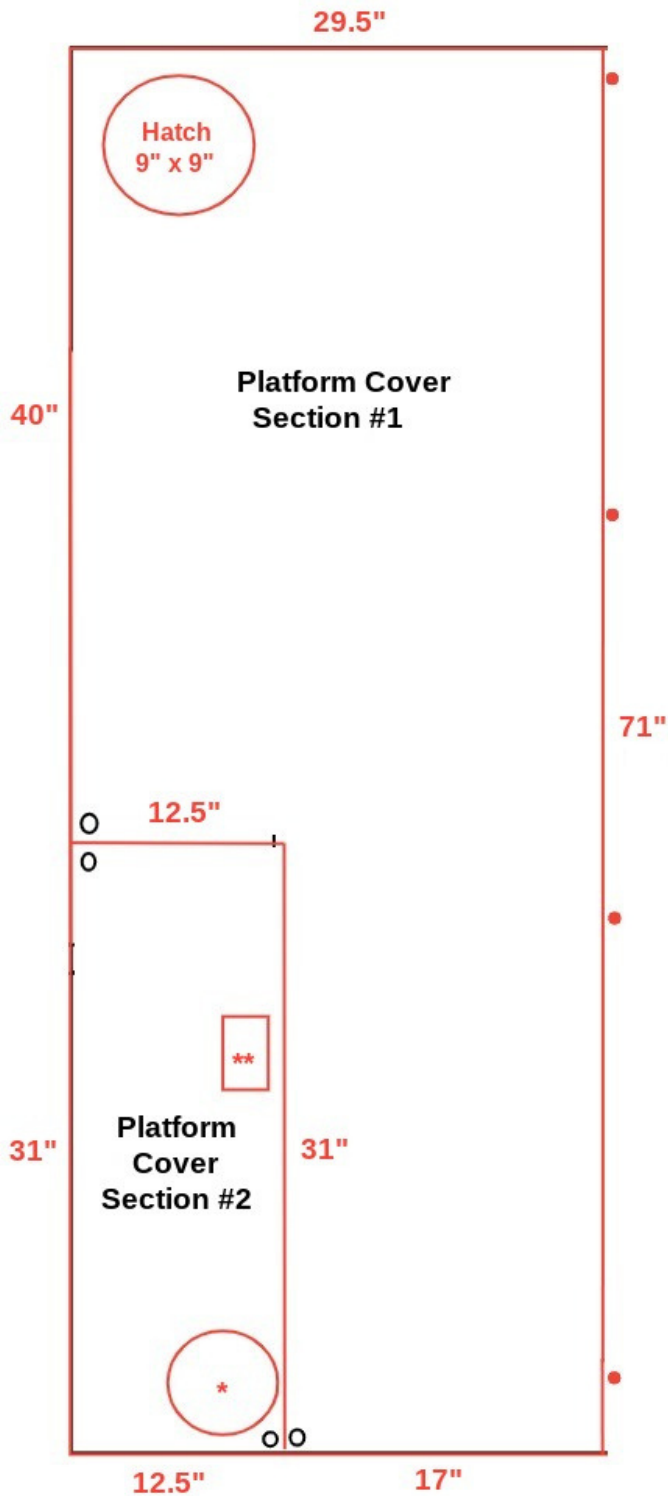

\* Optional cut out for Aluminum Propane Tank

\*\* Optional cut out for Solar Generator & Electrical Access

Toggle Latches secure Platform Cover Sections together

BACK



TAKETHETRUCK.COM